

# Artemide®

## Melampo Mega

design  
**A. Gardère**

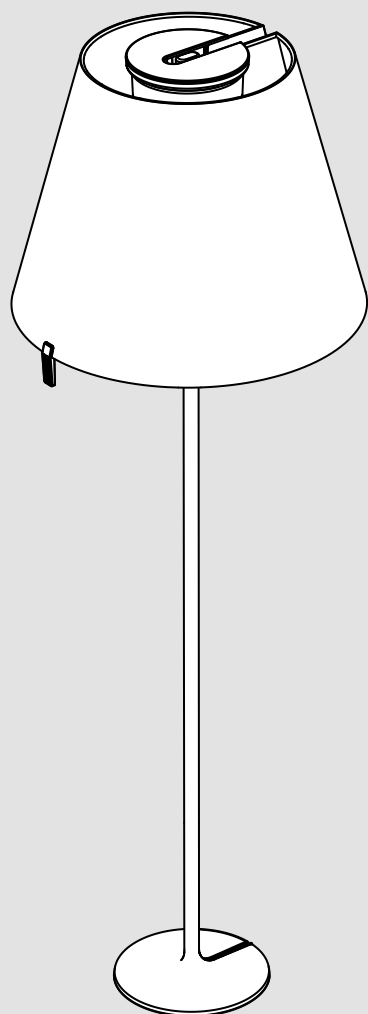



i

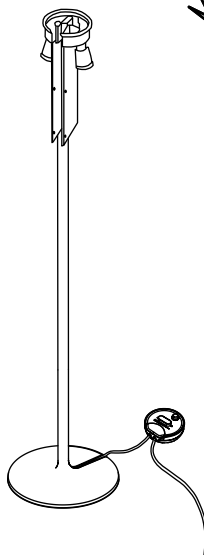
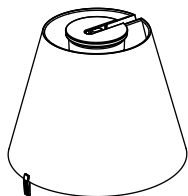
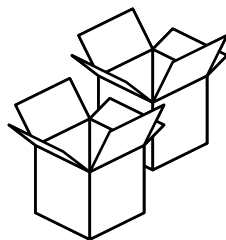
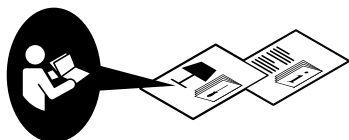
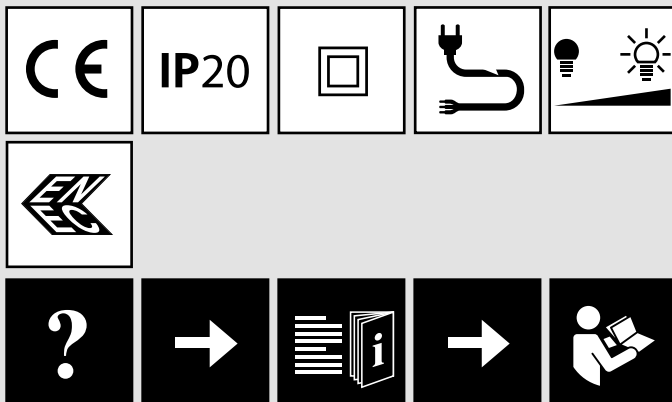

1

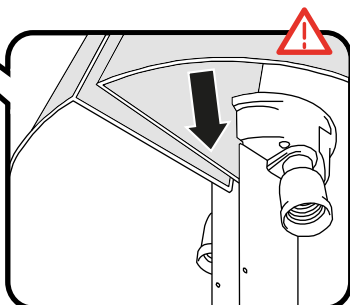
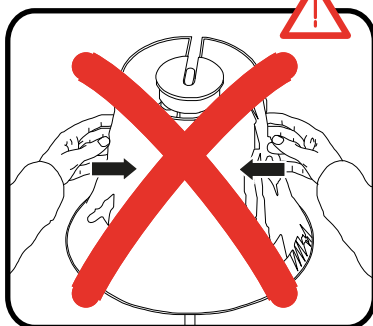
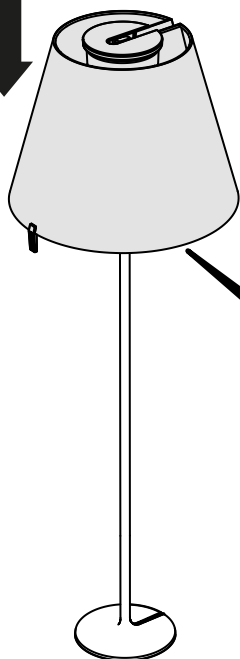

2

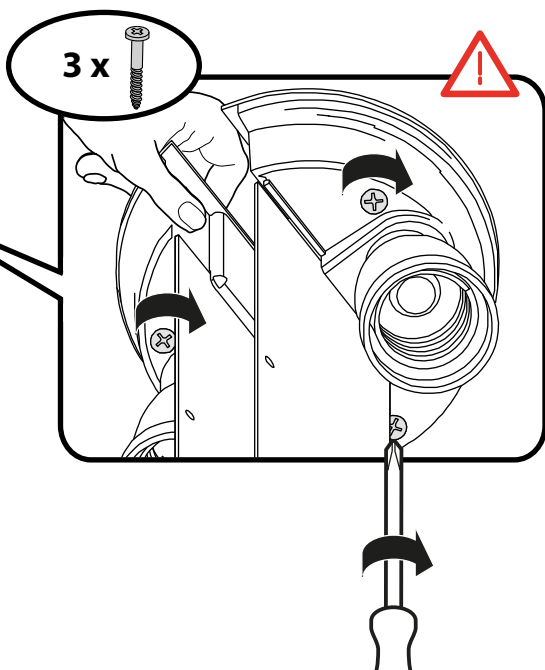
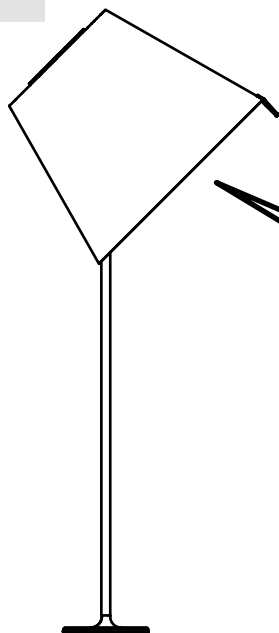

3

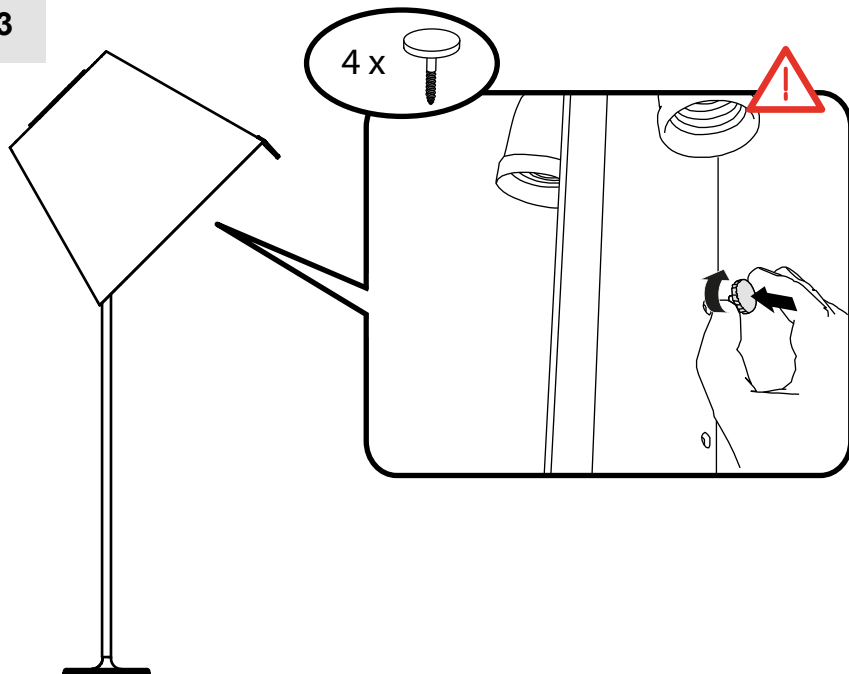

4

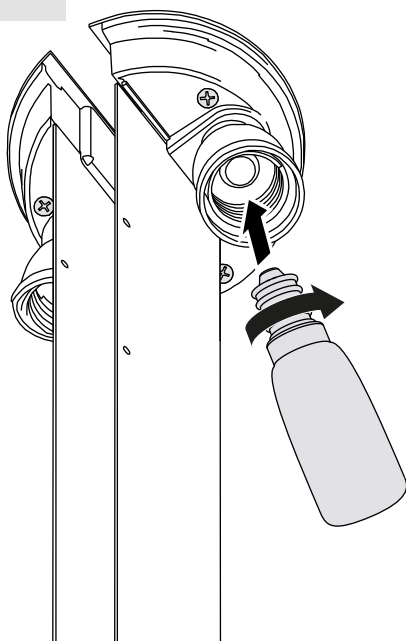

5

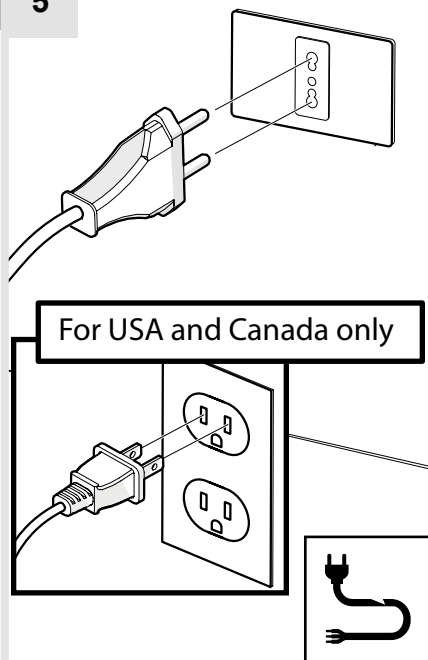

6

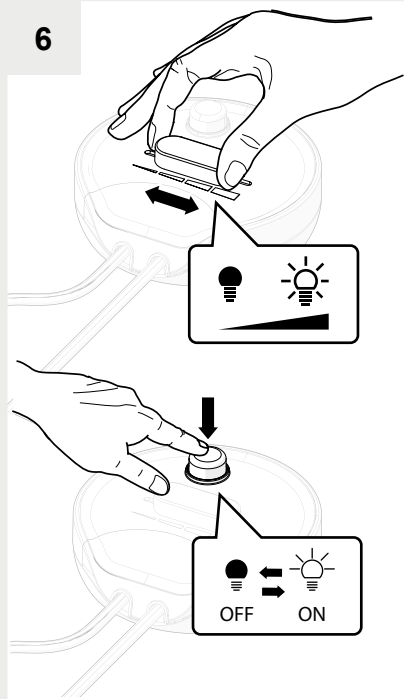

7

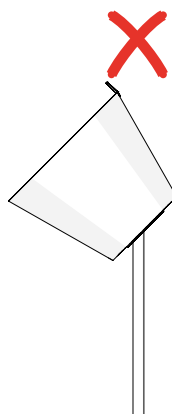
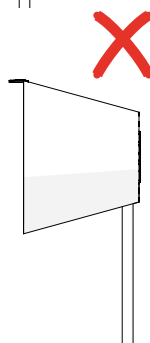
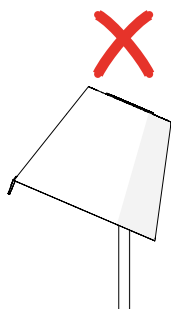
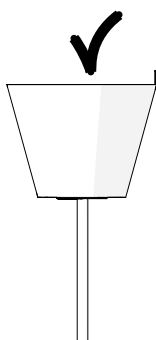
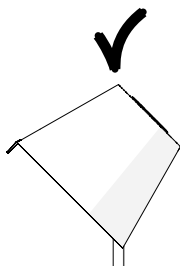
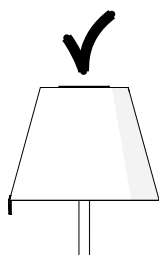
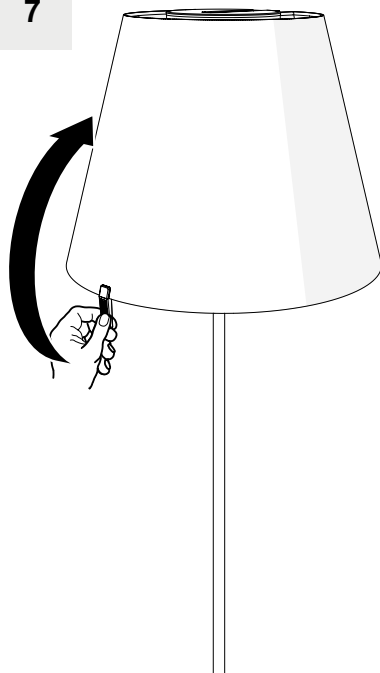



i

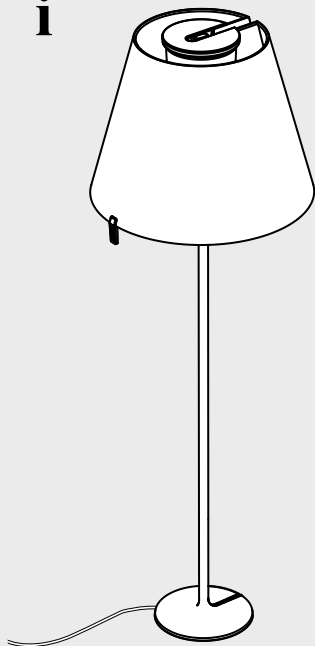

LED



HALO



HALO



FLUO

for USA/CANADA only

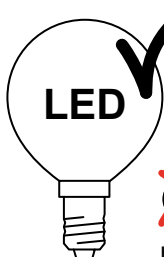

LED

**Bulb for USA/CAN:**

Max 2x25W E26

Type G or A

cULus SBLED



HALO



HALO



FLUO



4

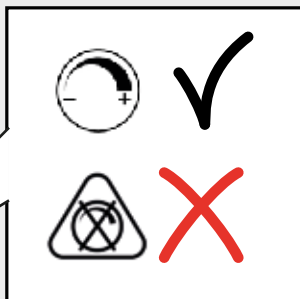
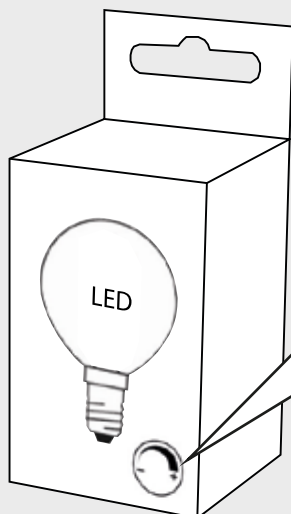

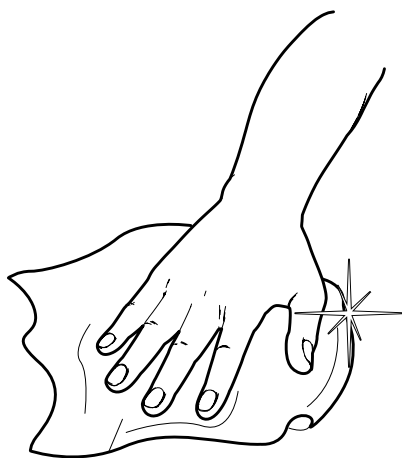

**Artemide®**

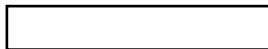

## **Artemide**

via Bergamo, 18  
20006 Pregnana M.se (MI)  
ITALIA

tel. +39 02 935 181  
fax +39 02 935 90 254  
fax +39 02 935 90 496

[www.artemide.com](http://www.artemide.com)

VAT IT00846890150

## **Artemide Inc.**

250 Karin Lane  
Hicksville, NY 11801

tel. 631 694 9292  
Toll Free 1-877-Art-9111  
Fax 631 694 9275

[www.artemide.net](http://www.artemide.net)

cod. Y513001125C